

Combined Schleifer K 3

H / K

05/13/2013

operating manual



GS grinding technology, on Lapwing trench 4, D-91315 Höchststadt
Phone: 09193-5018696 Fax: 09193-5018698

Table of Contents

A security

A.1 danger of the machine	4
A.2 Intended use	4
A.3 emissions	4
A.4 hazards	5
A.5 workplace	5
A.6 Authorized users	5
A.7 Personal protective equipment	5
A.8 Safety measures at site	5
A.9 do in an emergency	5
A.10 contained in this manual	6

B commissioning

B.1 Controls	7
B.2 Specifications	7
B.3 up the machine and connect	8th
Set B.4 grinding angle guides	8th
B.5 changing the grinding stones	8th

C operation

C.1 loops	8th
C.2 polishing and pull	9
C.3 grinding of cutter blades	9
C.4 Balligschleifen u. Polishing pre-ground cutting	9

E Cleaning and Maintenance

D.1 cleaning	10
D.2 maintenance	10
D.3 Permitted detergent	10
declaration of conformity	11
Spare parts list	12 + 13

Warranty Statement

The knife grinding machine K3 We grant a 12 month warranty from date of shipment when using the tool in one-shift operation. The warranty covers the free replacement of damaged or defective parts. Natural wear and tear, damage caused by grossly negligent treatment, as well as damages resulting from improper encryption application and unauthorized changes are excluded from the guarantee.

safety

Before starting up, always check:

Is the machine safe?

Is the direction of rotation?

A.1 hazards caused by the machine

The knife grinding machine is equipped with safety devices and a safety and acceptance test has undergone. Nevertheless, dangers, incorrect operation or abuse.

- To life and limb of the operator,
- for the machine and other property of the operator,
- for the efficient functioning of the machine.

All persons who are entrusted with the installation, commissioning, operation and maintenance of the machine must read the following instructions carefully. It's about your safety.

A.2 Intended use

The knife grinding machine is exclusively designed for grinding of knives in the food industry.

Unauthorized modifications and alterations to the machine are prohibited for safety reasons!

For damages resulting from improper use, the manufacturer / supplier is not liable. The risk **borne by the user. From the knife grinding machine K3 are harmful:**

- if not fully trained personnel,
- or not operated to the specified by the manufacturer. The intended use also includes observing the operating instructions and adherence to the care and maintenance guidelines!

A.3 emissions

The A-weighted equivalent continuous sound pressure level of this machine is below 70 dB (A).

There is no hearing protection required.

A.4 hazards



disconnect the plug before maintenance and cleaning on the blade grinder. Never remove safety devices or set of modifications to the machine out of service! Modifications and repairs to the electrical system may only be performed by a qualified electrician! Only use original spare parts from. GS-Schleiftechnik!

A.5 workplace

Workplace	front of the machine
work attitude	standing

A.6 Authorized users

The operator of the knife grinding machine K3 must provide the operator with the operating instructions accessible and make sure that he has read and understood it. The operator must ensure that only instructed and authorized persons work with the machine. The machine may only be operated by trained and authorized personnel and maintenance.

A.7 Personal protective equipment

For the operation, no special protective equipment is required. Eye protection is recommended.

A.8 Safety measures at site

The knife grinding machine K3 must be placed stable on a flat, fixed working table. The knife grinding machine K3 is suitable for use in damp rooms. Make sure by appropriate internal instructions and checks,



that the environment of the workplace is always clean and clear!

A.9 do in an emergency

In an emergency, the knife grinding machine K3 disconnect the power supply. In safety-related changes to the machine or its operating behavior, stop the machine immediately. The failure of the responsible person / place Report!

A.10 contained in this manual

Safety instructions in this manual are labeled as follows:

<p>Note:</p> 	<p>Warning!</p> 	<p>Danger !</p> 
<p>Special information regarding the economical use of the machine</p>	<p>Particular specifications or instructions and prohibitions for loss prevention</p>	<p>Specifications or instructions and prohibitions for the prevention of injuries and extensive property damage.</p>

<p>Warning!</p>
<p>Before maintenance and cleaning work on the grinder unplug the power cord! Never remove safety devices</p>
<p>or set of modifications to the machine out of service!</p>
<p>Only original spare parts from. GS use grinding technology!</p>

B. commissioning

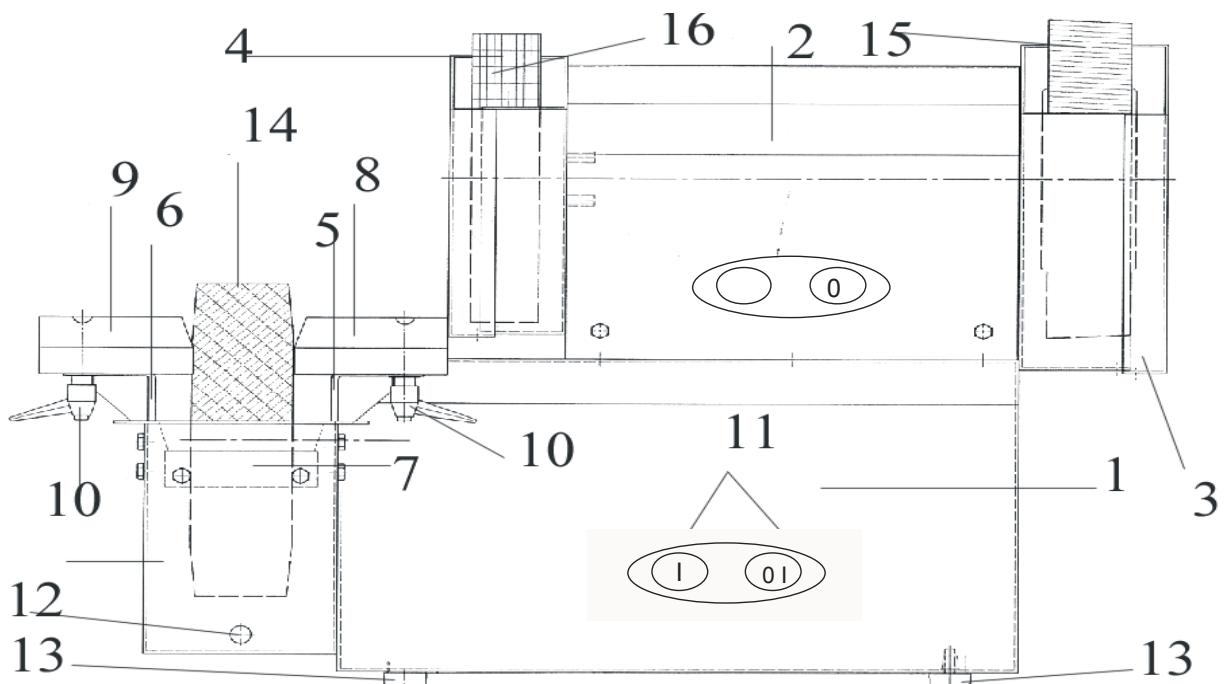

B.1 Controls

1 basic housing	9 grinding angle guide right
2 grinding motor cover	10 clamping lever
3 and cover lid Lam.	11 on and off button
4 Cover and lid Pol.	12 Water drain valve
5 grinding angle bracket right	13 rubber feet
6 grinding angle bracket left	14 Art grinding wheel
7 Wasserabstreifbürste	15 flap disc
8 grinding angle guide left	16 polishing wheel

B.2 Technical specifications

power supply	400V 5.8A 3 Ph
Housing and water basins	Stainless steel
Width / height / depth	650x550x480
grinding wheel	225x60x20 (240 grain)
Flap disc	250x50x20 (Grain 100 or 240)
buff	250x50x14
mass	52kg

B.3 install the machine and connect



Set the grinder on a firm, level surface. The machines may be operated only by a qualified electrician. Connect the machine to secure a 16A 400V three phase socket.

Check the direction of rotation! If these do not match, contact a qualified electrician!

Fill the basin about 10 cm high, with water.

Set B.4 grinding angle guides

After loosening the clamping lever, push the grinding angle guides to the wheels, so that a gap of about 1 / 2mm arises. Now screw the clamping lever firmly again. By pulling down the clamping lever you can rotate it, without the screw loose.

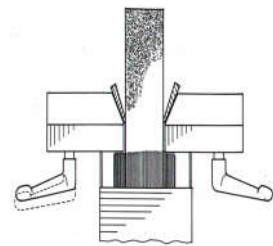

B.5 changing the grindstone

Remove the slip angle guides. Hold the sharpening stone with one hand and shoot with a key the clamping screw in the rotation direction of the grinding stone. Remove the screw with the clamping flange. Now you can remove the grinding wheel sideways. Installation is performed in reverse order. Before tightening the clamping screw, align the wheel by tapping out with a plastic hammer or a piece of wood.

C. operation

C.1 loops

Clean the knife before sharpening of grease and other residues. Insert the knife into the grinding angle guide and drag it with slight pressure along the cutting profile to himself. Several times alternately left and right of the wheel. Make sure that the blade is properly seated against the grinding angle guide for you to get a smooth finish. Grind your knife up to the cutting edge a continuous ridge is formed. In an old and slurred knife on, it takes a little longer until you achieve a smooth finish. Also, the hardness of the blade is critical to the grinding time.



Bild 1

C.2 polishing and honing

When honing and polishing repeat steps such as during grinding, but on the blade and polishing wheel. Important Always keep the blade in the direction of the disc! After a short time the cutting is polished. Pull now only with very light pressure. If the knife once honed and polished properly, you do not need to grind every time this regrinding. Grind them again when the blades no longer sharp by polishing and honing.

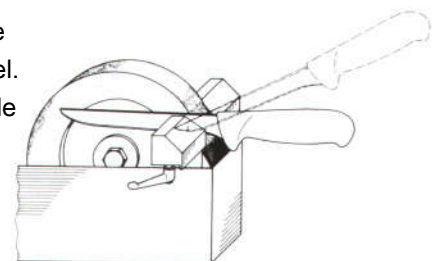
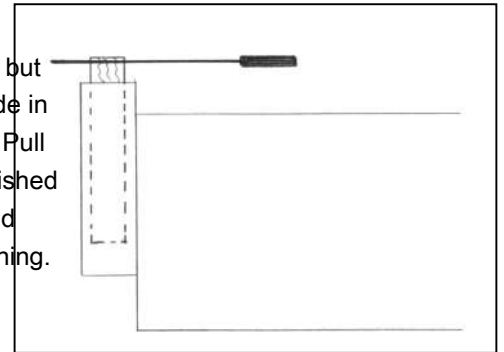

C.3 grinding of cutter blades

The cutter blades preground in the art grindstone with 2-3 areas. In each face a sample cut is to be performed. For this purpose the knife should be pressed briefly to the grinding wheel and the resulting surface can be controlled. Make sure that the blade is moved exactly in the grinding angle guide. By changing the grinding angle guide results in the required angle of the surface. It is advisable to grind the whole set of blades in each area to the frequent changing of the guides to spare. Please note the order only with one angle (7 °) then 2 (14 °) and 3 (21 °) at the end. Sickle blades should be sharpened without settle. This guarantees a smooth and flawless cutting quality.

C.4 Balligtschleifen and polishing of the pre-ground cutting

The pre-ground knives to grind crowned with light pressure on the flap disc, that is to equalize the pre-ground-sectional area paragraphs. The resulting at the cutting burrs must now be broken without pressure on the polishing and honing.

!!!!!!!!!!!!!! risk of accidents !!!!!!!!!!!!!!!

It is important to ensure that the cutting edge is not held against the direction of the polishing and honing!

D. cleaning and maintenance

D.1 cleaning

Has despite previous cleaning of the knife fat deposited on the grinding stones, add some degreasing detergent to the water. From time to time the water basin should be cleaned from grinding dust.

Warning!



Before maintenance and cleaning work on the grinder unplug the power cord! Never remove safety devices or set of modifications to the machine out of service!
Modifications and repairs to the electrical system may only be performed by a qualified electrician. Only use original spare parts from. GS Grinding Technology

D.2 maintenance

The grinding machine is completely maintenance-free. In the unlikely event a fault occur on your machine, please contact our customer service.

D.3 Permitted detergent

For cleaning and disinfecting the usual in the food industry methods and means have to be applied!

No high-pressure or steam cleaner

Use only legally approved detergent

EC declaration of conformity

in the sense of the
EC - Machinery Directive 2006/42 / EC,

for the
knife grinding machine K - 3 from serial No .: K3080001

The Company : **GS grinding technology at the
lapwing trench 4 D-91315
Höchstadt**

declares as manufacturer with sole responsibility that
**the knife grinding machine K - 3 with the requirements of the above Directive
matches.**

The following harmonized standards were applied:
EN ISO 12100-1: 2003; DIN EN ISO12100-2: 2003, Safety of machinery,
VDE 0100, VDE 0701/0702

Any unauthorized us change to the knife grinding machine
K - 3 This declaration loses its validity

GS grinding technology keeps ready a complete technical documentation for inspection.

Which belongs to the machine operating instructions is in the original version.

The conformity of the knife grinding machine K - 3 is ensured.

D-91315 Höchstadt, 06/11/2010

GS-Schleiftechnik
Management



Parts List K-3 Part 1

pcs	designation	Item No.:
1	1 basic housing	11225200000
2	1 Bodenabdeckblech	11225332000
3 4 5 6		
	1 pool of water left	11225310000
7	1 water drain valve (SWF 10638)	12630141501
8th	1 Wasserabstreifbürste	12225320000
9	1	
10	2 Grinding angle holder K-2 + 3 + 4 l / r	11225000003
11	1 Grinding angle guide right 14 °	12225141000
12	1 Grinding angle guide links 14 °	12225140000
13	1 Spring washers inside	12258810080
14	1 Spring washers outside	12258820080
15	1 clamping sleeve	11225220000
16 17		
18		
	1 F bearing housing. Ball bearings	12148110000
19	1 ball-bearing	12620200001
20 21		
22 23		
	4 rubber feet M8	12482530102
24 25		
	1 Motor 1	14225330031
26	1 Gear K-3 + 4 / N-22	13225446314
27 28		
	1 shaft K-3	12225314225
29 30		
	1 double pushbuttons	15225500000
31	1 Keys protective membrane	15225500002
32	1 Complete building block for twin pushbuttons	15225500001
33	1 auxiliary contactor	15225500003
34	1 cable 2m 4x1.5 mm ² CEE plug	15114152700
35	1 gland PG 11 with bend protection	15141110600
36	1 Mutter PG 11 for cable gland	15141116900
37 38		
39 40		
41		
	1 Art grinding wheel 225x60x20 (240)	20225602024
42	1 honing 225x60x20 (600)	21225602060
43 44		
45 46		
	1 sign direction of rotation	12225330031
47	2 Direction arrows	
48 49		
50		

Sho

Parts List K-3 Part 2 (T-25)

pcs		designation	Item No.:
1	1	Headers	11400250502
2	2	Side parts L / R	11225000251
3	1	Cover grinding motor	11225300310
4	1	Bodenabdeckblech	11225332001
5	2	Cover, Lam. + Pole.	11225320000
6	2	Cover for covering Lam. + Pol.	11225300251
7 8			
		2 threaded bolts M6 / A2 (283 mm long)	12250000015
9	4	cap nuts M6 / A2	18093406001
10 11			
12 13			
	1	Clamping flange for flap disc. Inside	12225300001
14	1	Clamping flange for leaf disk outside	12225300002
15	1	Mother M 20 left for flap disc	18093414002
16 17			
		clamping sleeve	11225220000
18 19			
	4	Schwingmetall M8-i / a	12225000125
20 21			
22 23			
24 25			
	1	Engine Type: DKF 80 G	14225330030
26 27			
28 29			
30			
	1	double pushbuttons	15225500000
31	1	Keys protective membrane	15225500002
32	1	complete module for double pushbuttons	15225500001
33	1	auxiliary contactor	15225500003
34	1	double pushbuttons	15225500000
35	1	connecting cable 2m, 4x1.5 mm ² , CEE plug 16A	15114152700
36	1	gland PG 11 with bend protection	15141110600
37 38			
39 40			
41			
	1	buff 250x50x14	27200352000
42	1	flap disc 250x50x20	25250502010
43	1	Hochglanzabziehpaste green	29100000000
44 45			
	1	nameplate	12225330051
46	2	Direction sign	12225330041
47	1	Stickers rotation direction	12225330031
48	1	sticker Glasses	12225330030
49 50			

Sho. 23/05/13